

New International Satin Finish



Widest range of best in class
Kitchen Sinks.

www.futurasink.com

Futura[®]
SINKS THAT THINK

Transforming Kitchens



COMPANY PROFILE

Since 1997, Futura Kitchen Sinks India Pvt. Ltd. has focused in carving the perfect sink to add splendor and grace to the kitchen interior.

The company has today evolved as one of the leading and reputed manufacturer of kitchen sinks and accessories.

Our products are manufactured at a state of the art facility in Bangalore, where attention is given to every detail from workmanship, aesthetics, utility and durability.

Behind our success lies the backing and strength of our highly qualified and extremely competent team who have rich experience in their respective fields, be it marketing or manufacturing. Our R & D team constantly strives to introduce the most innovative and latest designs that suit Indian conditions and yet carry an international appeal.

Futura[®] is the only Indian Brand with value addition in its products - we provide total solutions with our sinks - faucet, chopping board, basket, waste coupling, drainer kit etc. To add maximum variety and aesthetic appeal to our products, we have introduced a variety of finishes in our products - Satin, Brush Finish.

We also manufacture plumbing accessories in stainless steel and brass. All our products carry the same stamp of high quality and workmanship.

Vision :

To give every house the most hygienic & fulfilling experience of their kitchen in this life time for a life time.

Mission:

To give the latest, best & highest range of kitchen sinks with the best technology available to the customers.

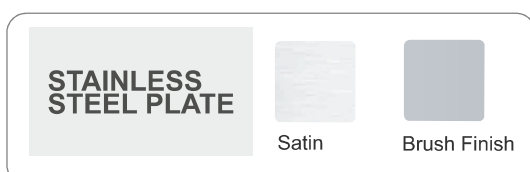

CONTENTS

FUTURA SINKS COLLECTIONS	Page No.
DURA SERIES	01 - 04
UNDER MOUNT SERIES	05
HAND CARVED SERIES	06 - 07
HAND CARVED COLOR SERIES	08
NATURAL QUARTZ SERIES	09 - 11
FOOD WASTE DISPOSER	11
FUTURA SINKS ACCESSORIES.....	12 - 13
FUTURA PLUMBLING ACCESSORIES	14 - 17

DURA SINGLE BOWL SQUARE SERIES

MODEL	DURA 16x14x7"
TECHNICAL DATA	
Overall Dimension:	16"x14" 406x356 mm
Bowl Dimension:	14"x12"x7" 356X305X175mm
FINISH	SATIN
M.R.P	Rs. 4350/-

Cabinet Size 18" Base

INSTALLATION: TOPMOUNT, UNDERMOUNT, INSET

MODEL	DURA 18x16x8"
TECHNICAL DATA	
Overall Dimension:	18"x16" 457x406 mm
Bowl Dimension:	16"x14"x8" 406X356X200mm
FINISH	SATIN
M.R.P	Rs. 4995/-

Cabinet Size 20" Base

INSTALLATION: TOPMOUNT, UNDERMOUNT, INSET

MODEL	DURA 18x18x8"
TECHNICAL DATA	
Overall Dimension:	18"x18" 457x457mm
Bowl Dimension:	16"x15"x8" 406X381X200mm
FINISH	SATIN
M.R.P	Rs. 5500/-

Cabinet Size 20" Base

INSTALLATION: TOPMOUNT, UNDERMOUNT, INSET

MODEL	DURA 19x16x8"
TECHNICAL DATA	
Overall Dimension:	19"x16" 482x406mm
Bowl Dimension:	16"x14"x8" 406X356X200mm
FINISH	SATIN
M.R.P	Rs. 5225/-

Cabinet Size 21" Base

INSTALLATION: TOPMOUNT, UNDERMOUNT, INSET

MODEL	DURA 19x19x8"
TECHNICAL DATA	
Overall Dimension:	19"x19" 482x482mm
Bowl Dimension:	16"x15"x8" 406X381X200mm
FINISH	SATIN
M.R.P	Rs. 5800/-

Cabinet Size 21" Base

INSTALLATION: TOPMOUNT, UNDERMOUNT, INSET

MODEL	DURA 20x17x8"
TECHNICAL DATA	
Overall Dimension:	20"x17" 506x430 mm
Bowl Dimension:	18"x15"x8" 455X380X200mm
FINISH	SATIN
M.R.P	Rs. 5850/-

Cabinet Size 24" Base

INSTALLATION: TOPMOUNT, UNDERMOUNT, INSET

MODEL	DURA 21x18x8"
TECHNICAL DATA	
Overall Dimension:	21"x18" 533x457mm
Bowl Dimension:	19"x16"x8" 482X406X200mm
FINISH	SATIN
M.R.P	Rs. 6250/-

Cabinet Size 23" Base

INSTALLATION: TOPMOUNT, UNDERMOUNT, INSET

MODEL	DURA 21x18x8"
TECHNICAL DATA	
Overall Dimension:	21"x18" 533x457mm
Bowl Dimension:	19"x16"x8" 482X406X200mm
FINISH	SATIN
M.R.P	Rs. 6250/-

DURA SINGLE BOWL SQUARE SERIES



MODEL	DURA 21x20x8"
TECHNICAL DATA	
Overall Dimension:	21"x20" 533x508mm
Bowl Dimension:	19"x16"x8" 482x406x200mm
FINISH	SATIN
M.R.P	Rs. 6850/-

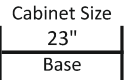
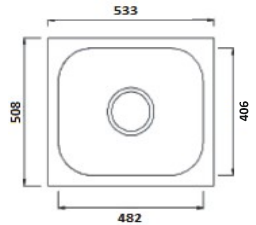

MODEL	DURA 22x18x8"
TECHNICAL DATA	
Overall Dimension:	22"x18" 559x457mm
Bowl Dimension:	19"x16"x8" 482x406x200mm
FINISH	SATIN
M.R.P	Rs. 6900 /-

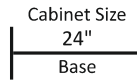
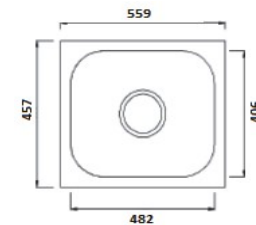

MODEL	DURA 24x18x8"
TECHNICAL DATA	
Overall Dimension:	24"x18" 609x457mm
Bowl Dimension:	22"x16"x8" 559x406x200mm
FINISH	SATIN
M.R.P	Rs. 7350/-

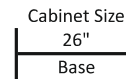
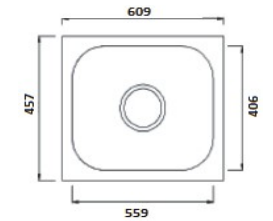

MODEL	DURA 24x18x9"
TECHNICAL DATA	
Overall Dimension:	24"x18" 609x457mm
Bowl Dimension:	22"x16"x9" 559x406x225mm
FINISH	SATIN
M.R.P	Rs. 7950/-

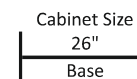
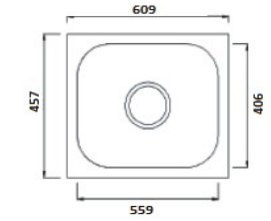

MODEL	DURA 24x18x10"
TECHNICAL DATA	
Overall Dimension:	24"x18" 609x457mm
Bowl Dimension:	22"x16"x10" 559x406x250mm
FINISH	SATIN
M.R.P	Rs. 8400/-

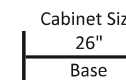
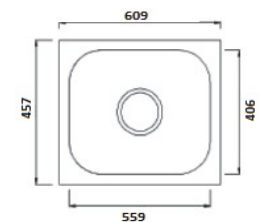

MODEL	DURA 24x20x8"
TECHNICAL DATA	
Overall Dimension:	24"x20" 609x508mm
Bowl Dimension:	22"x16"x8" 559x406x200mm
FINISH	SATIN
M.R.P	Rs. 7550/-

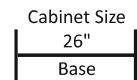
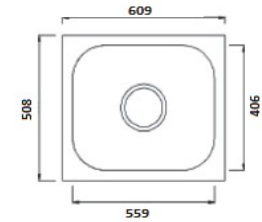

ROUND BOWL



MODEL	DURA 27x21x8"
TECHNICAL DATA	
Overall Dimension:	27"x21" 686x533mm
Bowl Dimension:	24"x18"x8" 612x457x200mm
FINISH	SATIN
M.R.P	Rs. 8750/-

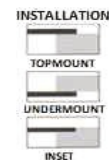
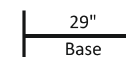
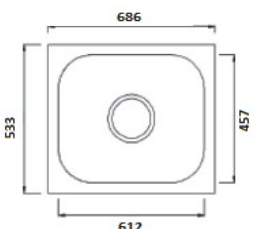

MODEL	FS 1818 R
TECHNICAL DATA	
Overall Dimension:	18"x18" 450x450mm
Bowl Dimension:	15 3/4"x15 3/4"x8" 390x390x200mm
FINISH	Pearl
M.R.P	Rs. 6450/-

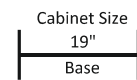
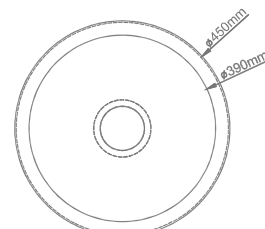

DURA SINGLE BOWL WITH DRAIN BOARD

MODEL	DURA 32x19x8"
TECHNICAL DATA	
Overall Dimension:	32"x19" 815x482mm
Bowl Dimension:	15"x16"x8" 381x406x200MM
FINISH	SATIN
M.R.P	Rs. 8910/-

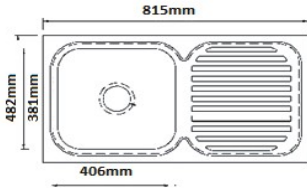



Cabinet Size: 17" Base

INSTALLATION: TOPMOUNT, UNDERMOUNT, INSET

DRAINER WASTE

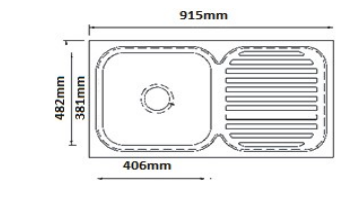
MODEL	DURA 36x19x8"
TECHNICAL DATA	
Overall Dimension:	36"x19" 915x482mm
Bowl Dimension:	16"x15"x8" 406x381x200mm
FINISH	SATIN
M.R.P	Rs. 9315/-





Cabinet Size: 18" Base

INSTALLATION: TOPMOUNT, UNDERMOUNT, INSET

DRAINER WASTE

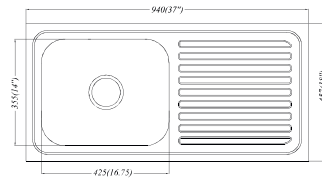
MODEL	DURA 37x18x8"
TECHNICAL DATA	
Overall Dimension:	37"x18" 940x457mm
Bowl Dimension:	16"x15"x8" 425x355x200mm
FINISH	SATIN
M.R.P	Rs. 9715/-





Cabinet Size: 18" Base

INSTALLATION: TOPMOUNT, UNDERMOUNT, INSET

DRAINER WASTE

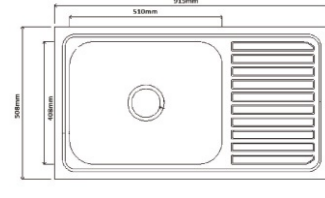
MODEL	DURA 36x20x8"
TECHNICAL DATA	
Overall Dimension:	36"x20" 915x508mm
Bowl Dimension:	20"x16"x8" 508x406x200mm
FINISH	SATIN
M.R.P	Rs. 10350/-





Cabinet Size: 22" Base

INSTALLATION: TOPMOUNT, UNDERMOUNT, INSET

DRAINER WASTE

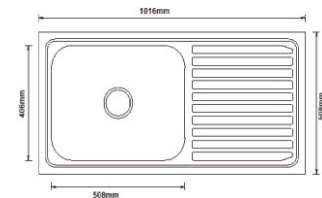
MODEL	DURA 40x20x8"
TECHNICAL DATA	
Overall Dimension:	40"x20" 1016x508mm
Bowl Dimension:	20"x16"x8" 508x406x200mm
FINISH	SATIN
M.R.P	Rs. 11450/-





Cabinet Size: 22" Base

INSTALLATION: TOPMOUNT, UNDERMOUNT, INSET

DRAINER WASTE

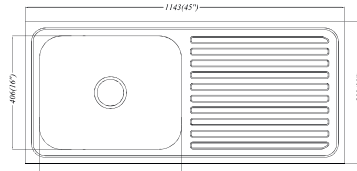
MODEL	DURA 45x20x8"
TECHNICAL DATA	
Overall Dimension:	45"x20" 1143x508mm
Bowl Dimension:	20"x16"x8" 508x406x200mm
FINISH	SATIN
M.R.P	Rs. 12425/-

Cabinet Size: 22" Base

INSTALLATION: TOPMOUNT, UNDERMOUNT, INSET

DRAINER WASTE

DURA SINGLE BOWL WITH DRAIN BOARD SQUARE SERIES

MODEL	FS 3618-P
TECHNICAL DATA	
Overall Dimension:	36"x18" 910x450mm
Bowl Dimension:	16½"x14"x8" 420x360x200mm
FINISH	SATIN
M.R.P	Rs. 8050/-

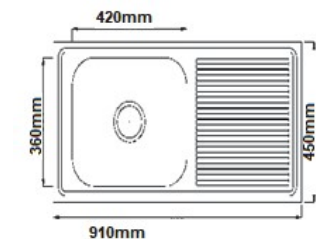



Cabinet Size: 18" Base

INSTALLATION: TOPMOUNT, UNDERMOUNT, INSET

DRAINER WASTE

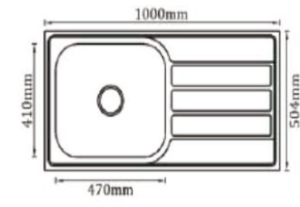
MODEL	FS 4020-P
TECHNICAL DATA	
Overall Dimension:	40"x20" 1000x504mm
Bowl Dimension:	18½"x16"x8" 470x410x200mm
FINISH	SATIN
M.R.P	Rs. 9200/-

Cabinet Size: 20" Base

INSTALLATION: TOPMOUNT, UNDERMOUNT, INSET

DRAINER WASTE

DURA VEG BOWL & VEG BOWL WITH DRAIN BOARD

MODEL	DURA 27x19x8"
TECHNICAL DATA	
Overall Dimension:	27"x19" 686x483"
Bowl Dimension:	16"x15"x8" 405x381x200mm
Small Bowl Dimension	8"x15x6" 203x405x160mm
FINISH	SATIN
M.R.P	Rs. 10575/-

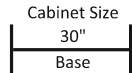
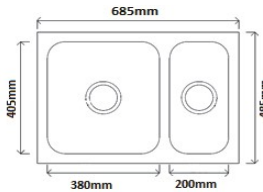

INSTALLATION



MODEL	DURA 40x20x8"
TECHNICAL DATA	
Overall Dimension:	40"x20" 1016x508mm
Bowl Dimension:	16"x15"x8" 405x381x200mm
Small Bowl Dimension	8"x15x6" 405x203x160mm
FINISH	SATIN
M.R.P	Rs. 15700/-

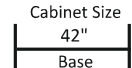
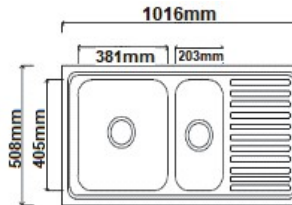

INSTALLATION



DURA DOUBLE BOWL

MODEL	DURA 37x18x8"
TECHNICAL DATA	
Overall Dimension:	37"x18" 940x457mm
Bowl Dimension:	15"x16"x8" 381x406x200mm
FINISH	SATIN
M.R.P	Rs. 12950/-

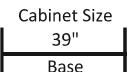
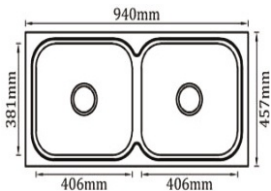

INSTALLATION



MODEL	DURA 31X18X7.5"
TECHNICAL DATA	
Overall Dimension:	31" x 18" 780x460
Bowl Dimension:	14"x12"x7.5" 360x305x185mm
FINISH	SATIN
M.R.P	Rs. 11500/-

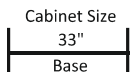
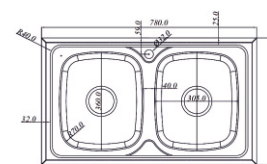

INSTALLATION



DURA DOUBLE BOWL

DURA DOUBLE BOWL WITH DRAIN BOARD

MODEL	DURA 45x20x9"
TECHNICAL DATA	
Overall Dimension:	45"x20" 1143x508 mm
Bowl Dimension:	20"x16"x8" 508x406x225mm
FINISH	SATIN
M.R.P	Rs. 15575/-

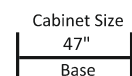
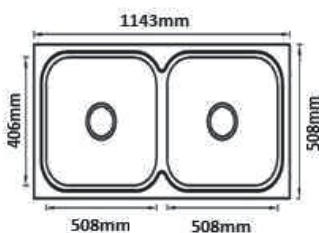

INSTALLATION

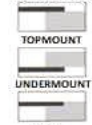

MODEL	DURA 47x20x8"
TECHNICAL DATA	
Overall Dimension:	47"x20" 1200x500mm
Bowl Dimension:	16"x14"x8" 406x355x210mm
FINISH	SATIN
M.R.P	Rs. 17725/-

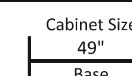
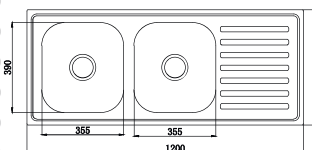

INSTALLATION



UNDERMOUNT SERIES



MODEL	FS 501
TECHNICAL DATA	
Overall Dimension:	18"x16"
	457x406mm
Bowl Dimension	16"x14"x9"
	406x355x230mm
EDGE	Plain
FINISH	SATIN
M.R.P	Rs. 6600/-

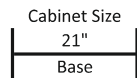
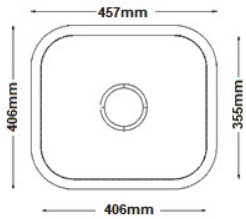

MODEL	FS 502
TECHNICAL DATA	
Overall Dimension:	21"x18"
	533x457mm
Bowl Dimension	19"x16"x9"
	482x406x230mm
EDGE	Plain
FINISH	SATIN
M.R.P	Rs. 7750/-

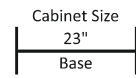
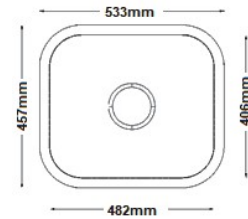

MODEL	FS 502 A
TECHNICAL DATA	
Overall Dimension:	24"x18"
	609x457mm
Bowl Dimension	22"x16"x9"
	559x406x230mm
EDGE	Plain
FINISH	SATIN
M.R.P	Rs. 9000/-

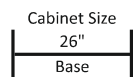
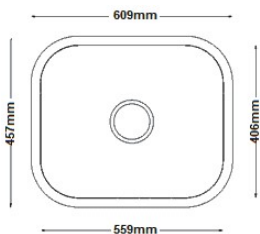

MODEL	FS 502 AA
TECHNICAL DATA	
Overall Dimension:	26"x20"
	660x508mm
Bowl Dimension	24"x18"x9"
	609x457x230mm
EDGE	Plain
FINISH	SATIN
M.R.P	Rs. 9250/-

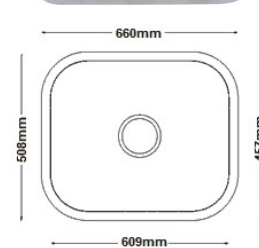

NEW PRODUCT

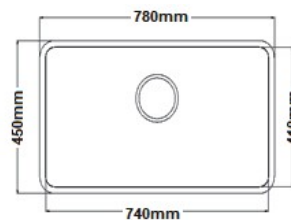
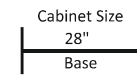

MODEL	FS 503
TECHNICAL DATA	
Overall Dimension:	31"x18"
	780x450mm
Bowl Dimension	29"x16"x9"
	740x410x230mm
EDGE	Plain
FINISH	SATIN
M.R.P	Rs. 10950/-

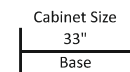

HAND CARVED SERIES (SINGLE BOWL)



MODEL	FS 1412 HM
TECHNICAL DATA	
Overall Dimension	14"x12" 355x304mm
Bowl Dimension	12"x10"x7" 304x254x175mm
FINISH	Brush
M.R.P	Rs. 6500/-

MODEL	FS 1816 HM
TECHNICAL DATA	
Overall Dimension:	18"x16" 460x405mm
Bowl Dimension	16"x14"x9" 420x364x225mm
FINISH	Brush
M.R.P	Rs. 10750/-



Cabinet Size
16"
Base

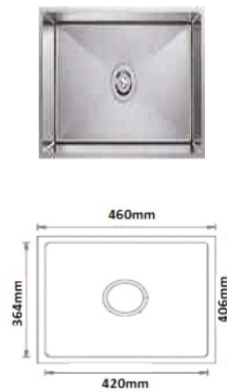
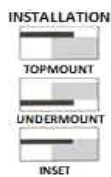

Cabinet Size
22"
Base

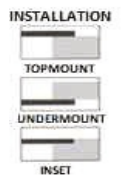

MODEL	FS 2118 HM
TECHNICAL DATA	
Overall Dimension:	21"x18" 533x457mm
Bowl Dimension	19"x16"x9" 483x407x225mm
FINISH	Brush
M.R.P	Rs. 13150/-

MODEL	FS 2418 HM
TECHNICAL DATA	
Overall Dimension	24"x18" 609x457mm
Bowl Dimension	22"x16"x9" 559x407x225mm
FINISH	Brush
M.R.P	Rs. 14600/-

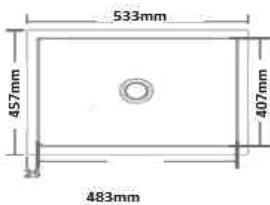

Cabinet Size
23"
Base

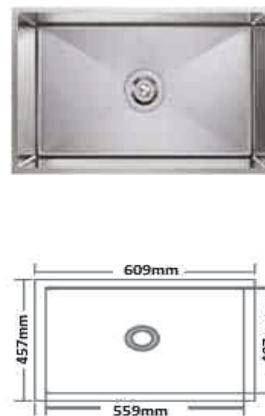
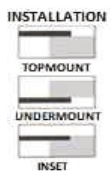

Cabinet Size
26"
Base

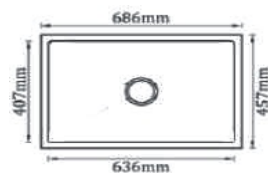
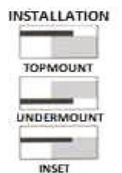

MODEL	FS 2718 HM
TECHNICAL DATA	
Overall Dimension	27"x18" 686x457mm
Bowl Dimension	25"x16"x9" 636x407x225mm
FINISH	Brush
M.R.P	Rs. 16500/-

Cabinet Size
29"
Base



HAND CARVED SERIES



MODEL	FS 2916 HM
TECHNICAL DATA	
Overall Dimension	29"x16" 750x400mm
Bowl Dimension	14"x14"x8" 350x350x200mm
FINISH	Brush
M.R.P	Rs. 17325/-

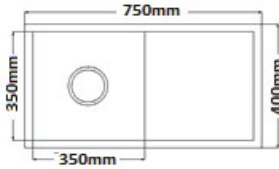

MODEL	FS 3620 HM
TECHNICAL DATA	
Overall Dimension	36"x20" 915x508mm
Bowl Dimension	18½"x17"x9" 470x444x225mm
FINISH	Brush
M.R.P	Rs. 19600/-

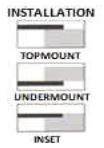
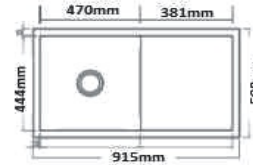

MODEL	FS 4020 HM
TECHNICAL DATA	
Overall Dimension:	40"x20" 1016x508mm
Bowl Dimension	21"x18"x9" 526x468x225mm
FINISH	Brush
M.R.P	Rs. 22475/-

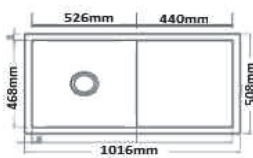

MODEL	FS 3618 DB HM
TECHNICAL DATA	
Overall Dimension:	36"x18" 915x457mm
Bowl Dimension	16 1/2"x16"x9" 419.5x406x225mm
FINISH	Brush
M.R.P	Rs. 20750/-

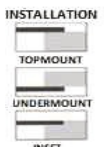
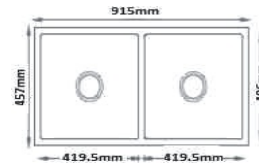

MODEL	FS 4520 DB HM
TECHNICAL DATA	
Overall Dimension	45"x20" 1143x508mm
Bowl Dimension	21"x18"x9" 534x458x225mm
FINISH	Brush
M.R.P	Rs. 24750/-

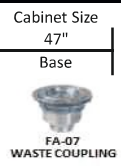
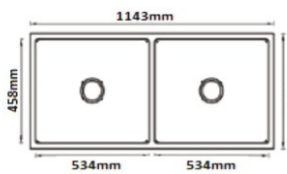

MODEL	FS 4520 HM
TECHNICAL DATA	
Overall Dimension	45"x20" 1143x508mm
Big Bowl Dimension	18½"x17"x9" 470x444x225mm
Small Bowl Dimension	8"x12"x8" 210x305x200mm
FINISH	Brush
M.R.P	Rs. 25250/-

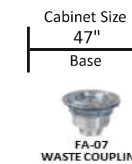
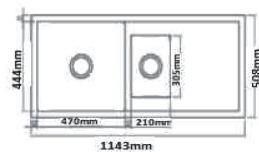

NEW
PRODUCT



MODEL	FS 4720 HM
TECHNICAL DATA	
Overall Dimension:	47"x20" 1193x508mm
Bowl Dimension	14 ½"x18"x8" 370x460x200mm
FINISH	Brush
M.R.P	Rs. 25950/-

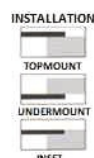
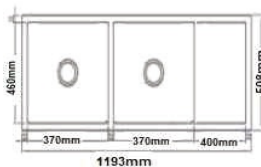

MODEL	FS 5118 HM
TECHNICAL DATA	
Overall Dimension	51"x18" 1295x457mm
Big Bowl Dimension	19"x15"x8" 483x393x200mm
Small Bowl Dimension	14"x15"x8" 356x393x200mm
FINISH	Brush
M.R.P	Rs. 28000/-

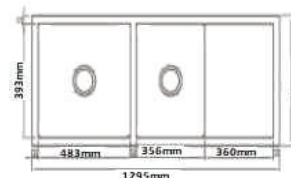

HAND CARVED COLOUR SERIES

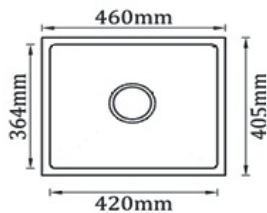

Colours Available Sink

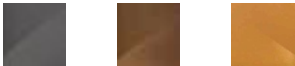

Black Copper Rose Rose Gold

Optional Accessories

FA-03AA FAUCET
MRP - 5600/-

Colours Available Faucet

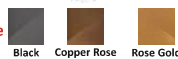

MODEL	FS 1816 HM
TECHNICAL DATA	
Overall Dimension	18"x16" 460x405mm
Bowl Dimension	16½"x14"x9" 420x364x225mm
FINISH	Flat
Available Colours	Black, Copper Rose, Rose Gold
M.R.P	Rs. 13175/-

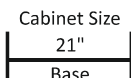

Coupling



INSTALLATION



NOTE: FAUCET AND WASTE COUPLING AVAILABLE SAME COLOURS

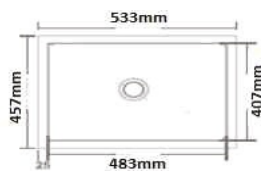

Colours Available Sink



Black Copper Rose Rose Gold

Optional Accessories

FA-03AA FAUCET
MRP - 5600/-

Colours Available Faucet



MODEL	FS 2118 HM
TECHNICAL DATA	
Overall Dimension:	21"x18"x9" 533x457x225mm
Bowl Dimension	19"x16"x9" 483x407x225mm
FINISH	Flat
Available Colours	Black, Copper Rose, Rose Gold
M.R.P	Rs. 16075/-

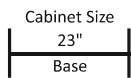

Coupling



INSTALLATION

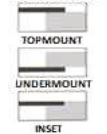

NOTE: FAUCET AND WASTE COUPLING AVAILABLE SAME COLOURS

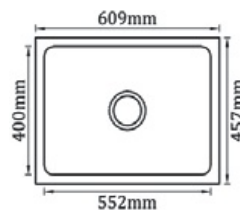

Colours Available Sink



Black Copper Rose Rose Gold

Optional Accessories

FA-03AA FAUCET
MRP - 5600/-

Colours Available Faucet

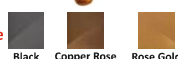

MODEL	FS 2418 HM
TECHNICAL DATA	
Overall Dimension:	24"x18"x9" 609x457x225mm
EDGE	Plain
FINISH	Flat
Available Colours	Black, Copper Rose, Rose Gold
M.R.P	Rs. 17825/-

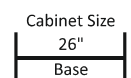

Coupling



INSTALLATION



NOTE: FAUCET AND WASTE COUPLING AVAILABLE SAME COLOURS

NATURAL QUARTZ SERIES

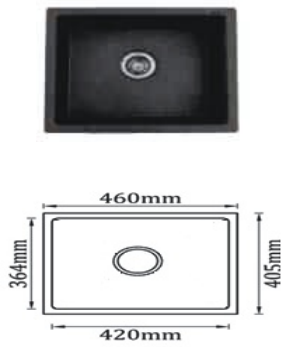

MODEL	FS 1816 NQ
TECHNICAL DATA	
Overall Dimension	18"x16" 460x410mm
Bowl Dimension	16½"x14"x8" 420x364x200mm
Available Colors	BP, GR, WHT, WS, WHI
FINISH	Natural Quartz
M.R.P	Rs. 7450/-

Cabinet Size
21"
Base

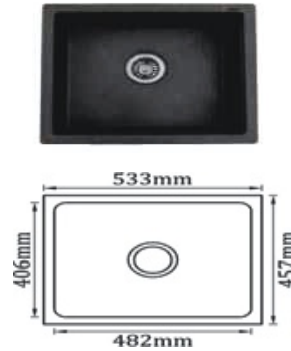

MODEL	FS 2118 NQ
TECHNICAL DATA	
Overall Dimension	21"x18" 533x457mm
Bowl Dimension	19"x16"x8" 482x406x200mm
Available Colors	BP, GR, WS, WHI
FINISH	Natural Quartz
M.R.P	Rs. 8400/-

Cabinet Size
23"
Base



MODEL	FS 2220 NQ
TECHNICAL DATA	
Overall Dimension	22"x20" 565x510mm
Bowl Dimension	19"x19"x8" 485x485x200mm
Available Colors	BP, GR, WS, WHI
FINISH	Natural Quartz
M.R.P	Rs. 10975/-

Cabinet Size
23"
Base

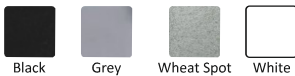

MODEL	FS 2418 NQ
TECHNICAL DATA	
Overall Dimension	24"x18" 609x457mm
Bowl Dimension	22"x16"x8" 552x400x200mm
Available Colors	BP, GR, WHT, WS, WHI
FINISH	Natural Quartz
M.R.P	Rs. 9075/-

Cabinet Size
26"
Base

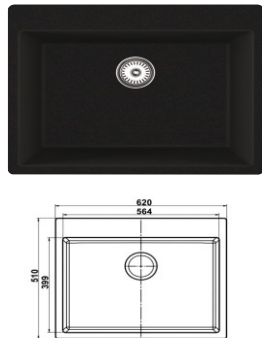

MODEL	FS 2420 NQ
TECHNICAL DATA	
Overall Dimension	24"x20" 620x510 mm
Bowl Dimension	22" x 19" x 8" 565x485x200 mm
Available Colors	BP, GR, WHT, WS, WHI
FINISH	Natural Quartz
M:R:P	Rs. 11600/-

Cabinet Size
26"
Base



MODEL	FS 3120 NQ
TECHNICAL DATA	
Overall Dimension	31"x20" 780x510 mm
Bowl Dimension	29" x 20" x 8" 724x400x200 mm
Available Colors	BP, GR, WHT, WS, WHI
FINISH	Natural Quartz
M:R:P	Rs. 13800/-

Cabinet Size
33"
Base



NEW
PRODUCT

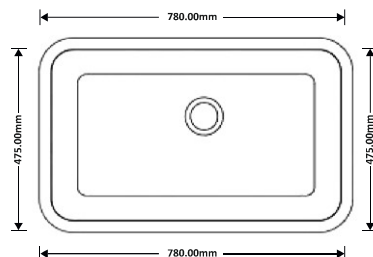

MODEL	FS 3119 NQ
TECHNICAL DATA	
Overall Dimension	31"x19" 780x475 mm
Bowl Dimension	31" x 19" x 8.5" 780x475x220 mm
Available Colors	BP, GR, WHT, WS, WHI
FINISH	Natural Quartz
M.R.P.	Rs. 13600/-

Cabinet Size
34"
Base



NATURAL QUARTZ SERIES

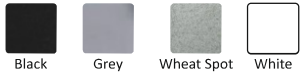
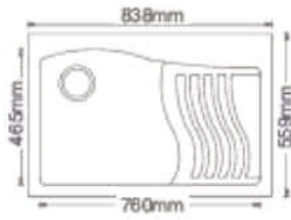

MODEL	FS 3322 NQ
TECHNICAL DATA	
Overall Dimension:	33x22"
	838x559mm
Bowl Dimension	30"x18"x10"
	760x465x250mm
Availabe Colors	BP, GR, WS, WHI
FINISH	Natural Quartz
M.R.P	Rs. 15675/-

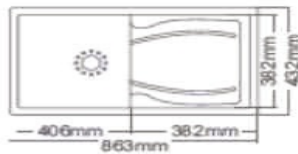
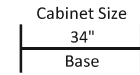

MODEL	FS 3417 NQ
TECHNICAL DATA	
Overall Dimension	34"x17"
	863x432mm
Bowl Dimension	16"x15"x8"
	406x382x200mm
Availabe Colors	BP, GR, WS, WHI
FINISH	Natural Quartz
M.R.P	Rs. 14175/-

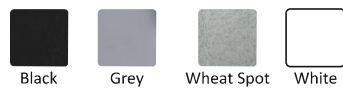
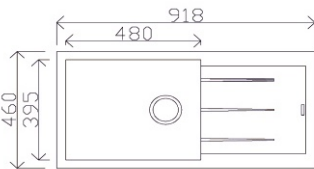
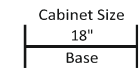

MODEL	FS 3618 NQ
TECHNICAL DATA	
Overall Dimension	36"x18"x9"
	900x450x230mm
Bowl Dimension	19"x15½"x9"
	480x395x230mm
Available Colors	BP, GR, WS, WHI
FINISH	Natural Quartz
M.R.P	Rs. 16500/-

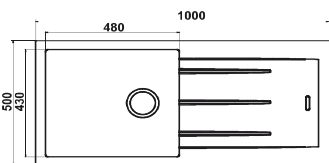
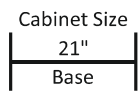

MODEL	FS 4020 NQ
TECHNICAL DATA	
Overall Dimension	40x20"
	1000x500mm
Bowl Dimension	21x17x9"
	510x430x225mm
Available Colors	BP, GR, WS, WHI
FINISH	Natural Quartz
M.R.P	Rs. 17350/-

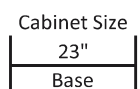

NATURAL QUARTZ SERIES

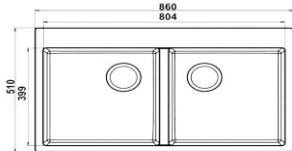

NEW
PRODUCT

MODEL	FS 3420 NQ
TECHNICAL DATA	
Overall Dimension	34"x20" 860x510 mm
Bowl Dimension	32" x 16" x 8" 804x399x200 mm
Availabe Colors	BP, GR, WHT, WS, WHI
FINISH	Natural Quartz
M:R:P	Rs. 17750/-

Cabinet Size
36"
Base

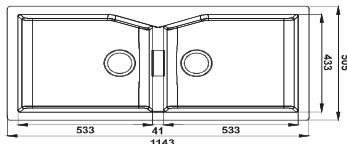

MODEL	FS 4520 NQ
TECHNICAL DATA	
Overall Dimension:	45"x20" 1125x500mm
Bowl Dimension	21x17x9" 510x430x225mm
Availabe Colors	BP, GR, WS, WHI
FINISH	Natural Quartz
M.R.P	Rs. 18750 /-

Cabinet Size
48"
Base

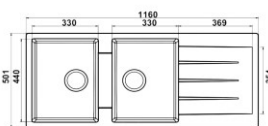
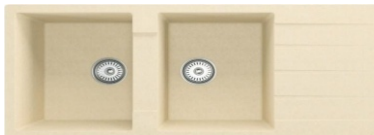

NEW
PRODUCT

MODEL	FS 4620 NQ
TECHNICAL DATA	
Overall Dimension	46"x20" 1160x500 mm
Bowl Dimension	13" x 17" x 8" 330x440x200 mm
Availabe Colors	BP, GR, WHT, WS, WHI
FINISH	Natural Quartz
M:R:P	Rs. 21600/-

Cabinet Size
48"
Base



SINK CABINET ACCESSORIES



NEW
PRODUCT

SIDE DRAWER BASKET

Product size :
D - 472 x W - 196 x H - 426

Cabinet size required Min :
D-482 x W- 214 x H - 564
M.R.P. ₹3725/-



NEW
PRODUCT

Swing Out Waste Bin - SS

Swing Out Dustbin
5 Ltr
M.R.P. ₹1800/-

Swing out dustbin
8 ltr
M.R.P. ₹2125/-

FOOD WASTE DISPOSER



FS 102 A

Overall Size:	202mmx330mm
Sink Mounting:	90 mm
Outlet :	1.5" BSP
Weight :	4.5KG
Motor :	1/2 hp
RPM :	2600
Power (W) :	370V
Uses :	Domestic
M.R.P. :	₹ 13800/-

ISO 9001 : 2015



We deliver consistent quality products as per ISO standardization.



For Stainless Steel Sinks.
Except Accessories and Complements.
Conditions apply.

FUTURA SINK ACCESSORIES

WALL TAP



FA-0AA - WALL TAP
M.R.P. ₹1775/-
HSN CODE : 8481

SINK TAP



FA-0BB - SINK TAP
M.R.P. ₹1775/-
HSN CODE : 8481

PULLOUT FAUCET



FA-01A - Pullout Faucet
M.R.P. ₹8550/-
HSN CODE : 8481

FAUCET



FA - 02
M.R.P. ₹3150/-
HSN CODE : 8481

QUARTZ FAUCET



FA-02A - Quartz Faucet
Available Colours Black,
White, Wheat, Grey
M.R.P. ₹4075/-
HSN CODE : 8481

QUARTZ FAUCET



FA-02AA - Quartz Faucet
Available Colours Black,
White, Wheat, Grey
M.R.P. ₹6050/-
HSN CODE : 8481

FAUCET



FA-02B - Faucet
Available Colours
Black, Wheat, Grey
M.R.P. ₹6550/-
HSN CODE : 8481

FAUCET



FA - 03A Faucet
M.R.P. ₹9225/-
HSN CODE : 8481

FAUCET



FA - 03AA Faucet
Available Colours Black,
Rose Copper, Rose Gold
M.R.P. ₹5600/-
HSN CODE : 8481

SINK TAP



FA-03C
M.R.P. ₹2550/-
HSN CODE : 8481

FAUCET TAP PULL OUT



FA-04A - TAP PULL OUT
M.R.P. ₹5500/-
HSN CODE : 7324

FAUCET TAP PULL OUT



FA-023IS
M.R.P. ₹10000/-
HSN CODE : 8481

FUTURA SINK ACCESSORIES

SOAP DISPENSER



FA-04 Soap Dispenser
M.R.P. ₹ 1000/-
HSN CODE : 7324

WASTE COUPLING



FA-05A
Size : 114mm
M.R.P. ₹ 650/-
HSN CODE : 7324

BASKET WASTE COUPLING



FA-06
Size : 128mm
M.R.P. ₹ 1450/-
HSN CODE : 7324

BASKET WASTE COUPLING



FA-07
Size : 114mm
M.R.P. ₹ 950/-
HSN CODE : 7324

DRAINER KIT (with Overflow)



FA-08
M.R.P. ₹ 1400/- (Without Waste Coupling)
M.R.P. ₹ 2650/- (With Waste Coupling)
HSN CODE : 3917

DRAINER KIT



FA-08A
M.R.P. ₹ 1350/- (Without Waste Coupling)
M.R.P. ₹ 2700/- (With Waste Coupling)
HSN CODE : 3917

DRAINER KIT



FA-08AA
M.R.P. ₹ 1750/- (Without Waste Coupling)
M.R.P. ₹ 3600/- (With Waste Coupling)
HSN CODE : 3917

DRAINER KIT (with Overflow)



FA-09A
M.R.P. ₹ 1250/- (Without Waste Coupling)
M.R.P. ₹ 1900/- (With Waste Coupling)
HSN CODE : 3917

DRAINER KIT (With Pop-Up)



FA-09AA
M.R.P. ₹ 2000/- (Without Waste Coupling)
M.R.P. ₹ 4800/- (With Waste Coupling)
HSN CODE : 3917

DRAINER KIT



FA-09B
M.R.P. ₹ 1200/- (Without Waste Coupling)
M.R.P. ₹ 1850/- (With Waste Coupling)
HSN CODE : 3917

DRAINER KIT SPACE SAVER



FA-09BB
M.R.P. ₹ 950/-
HSN CODE : 3917

SMALL WIRE BASKET



FA-12
M.R.P. ₹ 1050/-
HSN CODE : 7324

TUBE BASKET



FA-12B
M.R.P. ₹ 950/- (Small)
M.R.P. ₹ 1150/- (Big)
HSN CODE : 7324

SINK FIXING CLIP



FA-20
M.R.P. ₹ 200/-
HSN CODE : 7324

WALL MIXER



FA-03B
M.R.P. ₹ 3750/-
HSN CODE : 8481

WHY Futura[®] SINKS???



1



BASKET WASTE COUPLING:
Clog Free Easy to Maintain Small Bin In a waste Coupling For a Hygienic Wash Experience.

ISI CERTIFIED:
Our Sink Are Made With Indian Standards And We Are ISI Certified.

5

2



SS - 304:
Food Grade Stainless Steel With Which We Give 25 Years Of Warranty

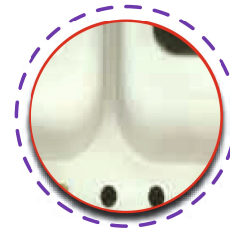

ANTI FUNGUS COATING:
Outer Bowl Is Layered With Anti Fungus & Anti Corrosive

6

3

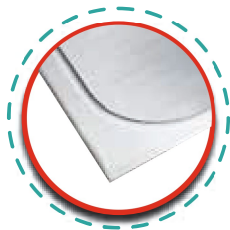

SOUND REDUCING PAD:
Special Sound Reduction Pad For a Better Wash Experience

7

1 MM THICKNESS:
Higher Thickness Steel As Per Indian Standard

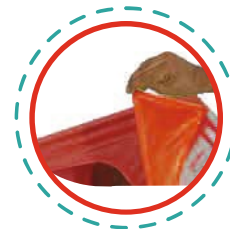

PLASTIC PROTECTIVE FILM:
All Our Sinks Comes With Plastic Film It Prevents Scratches Or Marks During Installation

8

4



SQUARE BOWL:
Minimum Radius Sinks With Squarish Bowl For Having Higher Volume Space For Washing.

REASONS TO CHOOSE US

Futura[®]
SINKS THAT THINK

FUTURA PLUMBING ACCESSORIES

Shower Channel Drainers | Gratings | Bathroom Accessories

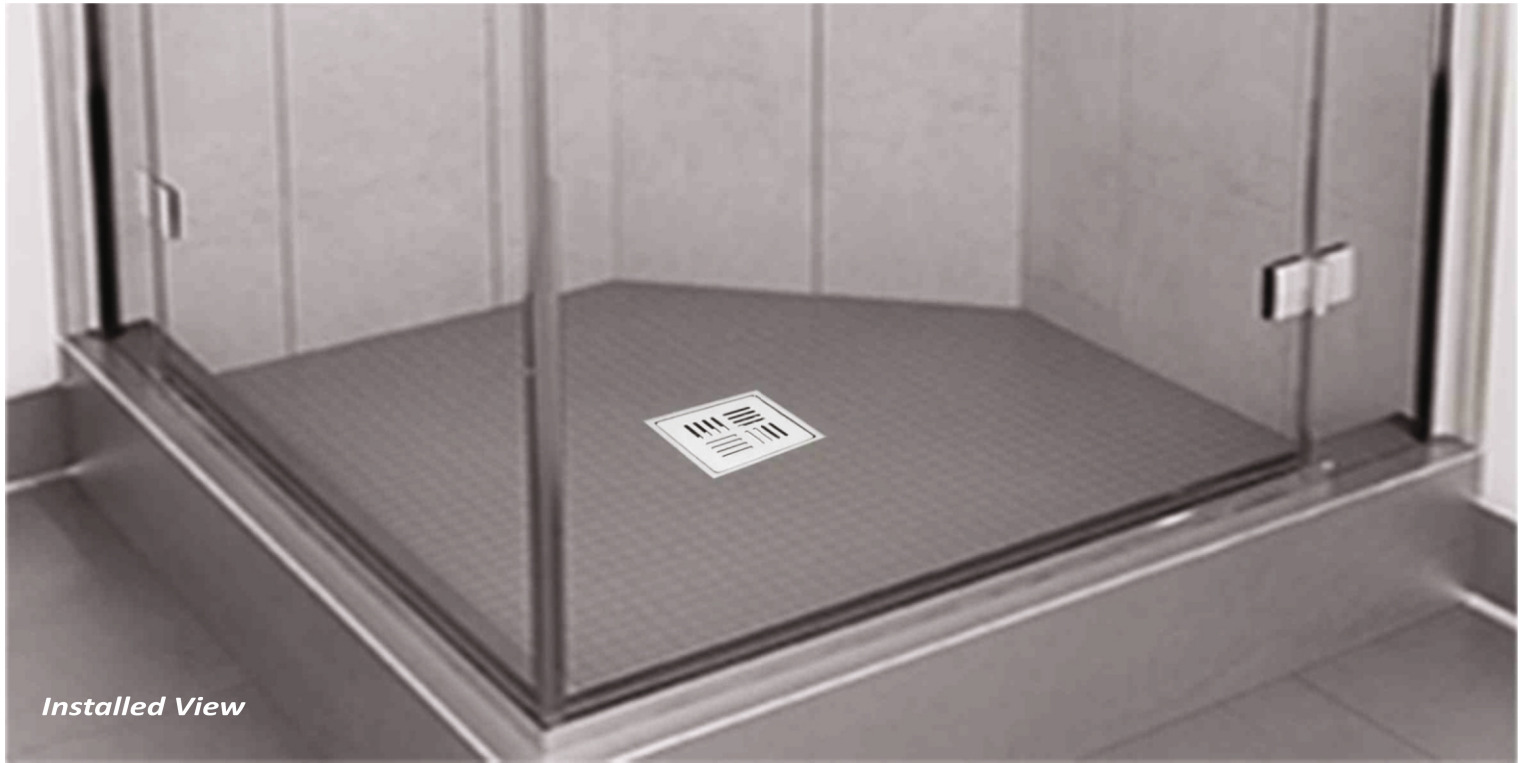

Installed View

SQUARE POPUP GRATING



NW - 001

Size: SS15 x 15 cms (6" x 6")
M.R.P. ₹ 900/-
HSN Code : 7326

SQUARE POPUP GRATING



NW - 002

Size: SS12.5 x 12.5 cms (5" x 5")
M.R.P. ₹ 800/-
HSN Code : 7326

SQUARE POPUP GRATING



NW - 002A

Size: SS10 x 10 cms (4" x 4")
M.R.P. ₹ 700/-
HSN Code : 7326

NEO GRATING



NW - 003-001

Size: SS15 x 15 cms (6" x 6")
M.R.P. ₹ 620/-
HSN Code : 7326

NW - 003-002

Size: SS12.5 x 12.5 cms (5" x 5")
M.R.P. ₹ 575/-
HSN Code : 7326

NEO GRATING



NW - 003-003

Size: SS15 x 15 cms (6" x 6")
M.R.P. ₹ 620/-
HSN Code : 7326

NW - 003-004

Size: SS12.5 x 12.5 cms (5" x 5")
M.R.P. ₹ 575/-
HSN Code : 7326

NEO GRATING



NW - 003-005

Size: SS15 x 15 cms (6" x 6")
M.R.P. ₹ 620/-
HSN Code : 7326

NW - 003-006

Size: SS12.5 x 12.5 cms (5" x 5")
M.R.P. ₹ 575/-
HSN Code : 7326

NEO GRATING



NW - 003-007

Size: SS15 x 15 cms (6" x 6")
M.R.P. ₹ 620/-
HSN Code : 7326

NW - 003-008

Size: SS12.5 x 12.5 cms (5" x 5")
M.R.P. ₹ 575/-
HSN Code : 7326

NEO GRATING



NW - 003-009

Size: SS15 x 15 cms (6" x 6")
M.R.P. ₹ 620/-
HSN Code : 7326

NEO GRATING



NW - 003-010

Size: SS15 x 15 cms (6" x 6")
M.R.P. ₹ 620/-
HSN Code : 7326

NW - 003-011

Size: SS12.5 x 12.5 cms (5" x 5")
M.R.P. ₹ 575/-
HSN Code : 7326

NEO GRATING



NW - 003-012

Size: SS15 x 15 cms (6" x 6")
M.R.P. ₹ 620/-
HSN Code : 7326

NEO GRATING

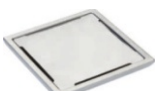

NW - 003-013

Size: SS15 x 15 cms (6" x 6")
M.R.P. ₹ 620/-
HSN Code : 7326

NW - 003-014

Size: SS12.5 x 12.5 cms (5" x 5")
M.R.P. ₹ 575/-
HSN Code : 7326

NEO GRATING



NW - 003-015

Size: SS15 x 15 cms (6" x 6")
M.R.P. ₹ 620/-
HSN Code : 7326

NW - 003-016

Size: SS12.5 x 12.5 cms (5" x 5")
M.R.P. ₹ 575/-
HSN Code : 7326

COCKROACH TRAP SQUARE FH



NW - 005

Size: SS15 x 15 cms (6" x 6")
M.R.P. ₹ 600/-
HSN Code : 7326

NW - 006

Size: SS12.5 x 12.5 cms (5" x 5")
M.R.P. ₹ 550/-
HSN Code : 7326

COCKROACH TRAP SQUARE FH



NW - 006B

Size: SS10 x 10 cms (4" x 4")
M.R.P. ₹ 500/-
HSN Code : 7326

FH - FULL HOLE CH - CENTRE HOLE

FUTURA PLUMBING ACCESSORIES

COCKROACH TRAP SQUARE CH



NW - 005A

Size: SS15 x 15 cms (6" x 6")
M.R.P. ₹ 600/-
HSN Code : 7326

NW - 006A

Size: SS12.5 x 12.5 cms (5" x 5")
M.R.P. ₹ 550/-
HSN code : 7326

COCKROACH TRAP SQUARE CH



NW - 006C

Size: SS10 x 10 cms (4" x 4")
M.R.P. ₹ 500/-
HSN Code : 7326

COCKROACH TRAP CLASSIC



NW - 006D

Size: SS15 x 15 cms (6" x 6")
M.R.P. ₹ 650/-
HSN Code : 7326

NW - 006E

Size: SS12.5 x 12.5 cms (5" x 5")
M.R.P. ₹ 575/-
HSN Code : 7326

COCKROACH TRAP ROUND FH



NW - 007

Size: SS12.5cms (5")
M.R.P. ₹ 525/-
HSN Code : 7326

COCKROACH TRAP ROUND CH



NW - 007A

Size: SS12.5cms (5")
M.R.P. ₹ 525/-
HSN Code : 7326

LIFE STYLE SQUARE GRATING WITH HINGES FH



NW - 009

Size: SS15 cms (6"x6")
M.R.P. ₹ 230/-
HSN Code : 7326

LIFE STYLE SQUARE GRATING WITH HINGES CH



NW - 009A

Size: SS15 cms (6"x6")
M.R.P. ₹ 230/-
HSN Code : 7326

DELUXE ROUND FRAME GRATING WITH LOKCING SYS. FH



NW - 010

Size: SS12.5cms (5")
M.R.P. ₹ 160/-
HSN Code : 7326

DELUXE ROUND FRAME GRATING WITH LOKCING SYS. CH



NW - 010A

Size: SS12.5cms (5")
M.R.P. ₹ 160/-
HSN Code : 7326

SUPER ROUND FRAME GRATING FH



NW - 011

Size: SS12.5cms (5")
M.R.P. ₹ 150/-
HSN Code : 7326

SUPER ROUND FRAME GRATING CH



NW - 011A

Size: SS12.5cms (5")
M.R.P. ₹ 150/-
HSN Code : 7326

ECO ROUND FRAME GRATING WITH LOCKING SYS FH



NW - 012
Size: SS12.5cms (5")
M.R.P. ₹ 140/-
HSN Code : 7326

NW - 012B

Size: SS7.5cms (3")
M.R.P. ₹ 120/-
HSN Code : 7326

ECO ROUND FRAME GRATING WITH LOCKING SYS CH



NW - 012A

Size: SS12.5cms (5")
M.R.P. ₹ 140/-
HSN Code : 7326

ROUND SINGLE GRATING FH



NW - 013

Size: SS12.5cms (5")
M.R.P. ₹ 90/-
HSN Code : 7326

NW - 013B

Size: SS7.5cms (3")
M.R.P. ₹ 80/-
HSN Code : 7326

ROUND SINGLE GRATING CH



NW - 013A

Size: SS12.5cms (5")
M.R.P. ₹ 90/-
HSN Code : 7326

SQUARE FRAME GRATING WITH LOCKING SYS. FH



NW - 015

Size: SS15 x 15 cms (6" x 6")
M.R.P. ₹ 200/-
HSN Code : 7326

NW - 016

Size: SS12.5 x 12.5 cms (5" x 5")
M.R.P. ₹ 190/-
HSN Code : 7326

SQUARE FRAME GRATING WITH LOCKING SYS. CH



NW - 015A
Size: SS15 x 15 cms (6" x 6")
M.R.P. ₹ 200/-
HSN Code : 7326

NW - 016A

Size: SS12.5 x 12.5 cms (5" x 5")
M.R.P. ₹ 190/-
HSN Code : 7326

SQUARE FRAME GRATING WITH LOCKING SYS. FH



NW - 017

Size: SS10 x 10 cms (4" x 4")
M.R.P. ₹ 180/-
HSN Code : 7326

SUPER SQUARE FRAME GRATING FH



NW - 017A

Size: SS15 x 15 cms (6" x 6")
M.R.P. ₹ 220/-
HSN Code : 7326

NW - 017C

Size: SS12.5 x 12.5 cms (5" x 5")
M.R.P. ₹ 200/-
HSN Code : 7326

Super Square Frame Grating CH



NW - 017B

Size: SS15 x 15 cms (6" x 6")
M.R.P. ₹ 220/-
HSN Code : 7326

NW - 017D

Size: SS12.5 x 12.5 cms (5" x 5")
M.R.P. ₹ 200/-
HSN Code : 7326

SQUARE FRAME GRATING WITH LOCKING SYS. WITH LID



NW - 16AA

Size: SS12.5 x 12.5 cms (5" x 5")
M.R.P. ₹ 350/-
HSN Code : 7326

NW - 17AA

Size: SS15 x 15 cms (6" x 6")
M.R.P. ₹ 400/-
HSN Code : 7326

SQUARE SINGLE GRATING FH



NW - 018

Size: SS15 x 15 cms (6" x 6")
M.R.P. ₹ 140/-
HSN Code : 7326

NW - 019

Size: SS12.5 x 12.5 cms (5" x 5")
M.R.P. ₹ 130/-
HSN Code : 7326

SQUARE SINGLE GRATING CH



NW - 018A

Size: SS15 x 15 cms (6" x 6")
M.R.P. ₹ 140/-
HSN Code : 7326

NW - 019A

Size: SS12.5 x 12.5 cms (5" x 5")
M.R.P. ₹ 130/-
HSN Code : 7326

SQUARE SINGLE GRATING FH



NW - 020

Size: SS10 x 10 cms (4" x 4")
M.R.P. ₹ 110/-
HSN Code : 7326

FLOOR CLEAN OUT



NW - 020AA

Size: SS12.5 x 12.5 cms (5" x 5")
M.R.P. ₹ 235/-
HSN Code : 7326

NW - 020BB

Size: SS15 x 15 cms (6" x 6")
M.R.P. ₹ 335/-
HSN Code : 7326

LONG FLOOR DRAIN - OPTIONAL



NW - 021

Size: SS Long Floor 4 x 24"
M.R.P. ₹ 4300/-
HSN Code : 7326

NW - 021A

Size: SS Long Floor 4 x 31½"
M.R.P. ₹ 5800/-
HSN Code : 7326

LONG FLOOR DRAIN - DOT SET



NW - 021AA

Size: SS Long Floor 4 x 24"
M.R.P. ₹ 4300/-
HSN Code : 7326

NW - 021BB

Size: SS Long Floor 4 x 31½"
M.R.P. ₹ 5800/-
HSN Code : 7326

LONG FLOOR DRAIN - STRIP SET



NW - 021CC

Size: SS Long Floor 4 x 24"
M.R.P. ₹ 4300/-
HSN Code : 7326

NW - 021DD

Size: SS Long Floor 4 x 31½"
M.R.P. ₹ 5800/-
HSN Code : 7326

Customised sizes available

Customised sizes available

Customised sizes available

FUTURA PLUMBING ACCESSORIES

**SQUARE FLOOR DRAIN
OPTIONAL**



NW - 021B

Size: SS15 x 15 cms (6" x 6")
M.R.P. ₹1350/-
HSN Code : 7326

NW - 21BB

Size: SS12.5 x 12.5 cms (5" x 5")
M.R.P. ₹1140/-
HSN Code : 7326

CLASSIC SQUARE GRATING



NW - 022

Size: SS15 x 15 cms (6" x 6")
M.R.P. ₹250/-
HSN Code : 7326

NW - 022A

Size: SS12.5 x 12.5 cms (5" x 5")
M.R.P. ₹200/-
HSN Code : 7326

CLASSIC SQUARE GRATING



NW - 022B

Size: SS10 x 10 cms (4" x 4")
M.R.P. ₹170/-
HSN Code : 7326

BALCONY SQUARE GRATING



NW - 022CC

Size: SS8 X 8 cms (3" x 3")
M.R.P. ₹140/-
HSN Code : 7326

**SS Horizontal/Vertical
Square Grating**



NW - 023

Size: SS10 x 10 cms (4" x 4")
M.R.P. ₹150/-
HSN Code : 7326

**SS HORIZONTAL/VERTICAL
SQUARE GRATING**



NW - 023B

Size: SS15 x 15 cms (6" x 6")
M.R.P. ₹250/-
HSN Code : 7326

NW - 023A

Size: SS12.5 x 12.5 cms (5" x 5")
M.R.P. ₹200/-
HSN Code : 7326

**SS HORIZONTAL/VERTICAL
TERRACE FLOOR DRAIN**



NW - 023AA

Size: SS10 x 7.5 cms
M.R.P. ₹1250/-
HSN Code : 7326

**SS WITH ABS BASE HORIZONTAL
& VERTICAL WALL/TERRACE FLOOR
DRAIN**



NW - 023BB

Size: SS11.5 x 12.5 cms
M.R.P. ₹850/-
Outlet : 75 mm
HSN Code : 7326

OUTER PIPE DOOM CLOSER



NW - 023CC

Size: SS7.5 x 6.5 cms
M.R.P. ₹550/-
HSN Code : 7326

OUTER PIPE DOOM CLOSER



NW - 023DD

Size: SS12.5 x 10 cms
M.R.P. ₹700/-
HSN Code : 7326

WALL FLANGE DOOM



NW - 024

Size: SS Big Doom Hole 22mm
M.R.P. ₹30/-
HSN Code : 7307

WALL FLANGE SQUARE

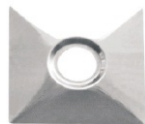

NW - 024A

Size: SS Big Square 22mm
M.R.P. ₹40/-
HSN Code : 7307

WALL FLANGE FLAT BIG



NW - 025

Size: SS Big Flat 22mm
M.R.P. ₹30/-
HSN Code : 7307

WALL FLANGE FLAT SMALL



NW - 025A

Size: SS Small Flat 22mm
M.R.P. ₹28/-
HSN Code : 7307

WASTE COUPLING FT



NW - 032

Size: Waste Coupling Brass1 x 1/4"
M.R.P. ₹390/-
HSN Code : 7418

WASTE COUPLING HT



NW - 032A

Size: Waste Coupling Brass1 x 1/4"
M.R.P. ₹390/-
HSN Code : 7418

WASTE COUPLING LONG FT



NW - 033

Size: Waste Coupling Long1 x 1/4"
M.R.P. ₹550/-
HSN Code : 7418

WASTE COUPLING POP-UP



NW - 034

Size: Brass 1 x 1/4"
M.R.P. ₹800/-
HSN Code : 7418

WASTE COUPLING POP-UP



NW - 034B

Size: Brass 1 x 1/4"
M.R.P. ₹750/-
HSN Code : 7418

SPACE SAVER BOTTLE TRAP



NW - 035

Size: B/T Set-Brass Pipe-9 x 12"
M.R.P. ₹850/-
Colour Available: Gray
HSN Code : 3917

BOTTLE TRAP SET WITH PIPE



NW - 037

Size: B/T Set-Brass Pipe 6"x9"
M.R.P. ₹1430/-

NW - 037A

Size: B/T Set-Brass Pipe 9"x12"
M.R.P. ₹1630/-
HSN Code : 7418

BOTTLE TRAP SET WITH PIPE



NW - 037B

Size: B/T Set-Brass Pipe 6"x9"

NW - 037D

Size: B/T Set-Brass Pipe 9"x12"
M.R.P. ₹1800/-
HSN Code : 7418

BOTTLE TRAP SET WITH FLAP COVER

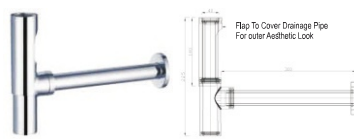

NW-037C

Item : B/T set - Brass Pipe - 5"x12"
M.R.P. ₹ 2000/-
HSN Code : 7418

BOTTLE TRAP PIPE



NW - 038

Brass Pipe-OD-30mm Size-12"
M.R.P. ₹450/-
HSN Code : 7418

NW - 039

Brass Pipe-OD-30mm Size-18"
M.R.P. ₹675/-
HSN Code : 7418

BOTTLE TRAP PIPE



NW - 038A

Brass Pipe-OD-32mm Size-12"
M.R.P. ₹450/-
HSN Code : 7418

NW - 039A

Brass Pipe-OD-32mm Size-18"
M.R.P. ₹675/-
HSN Code : 7418

"P" TRAP



NW - 040

Brass-Pipe Size-6" x 9" (80mm)
M.R.P. ₹1250/-
HSN Code : 7418

NW - 040A

Brass-Pipe Size-9" x 12" (80mm)
M.R.P. ₹1450/-
HSN Code : 7418

"P" TRAP-Vertical Pipe



NW - 040AA

Brass-Pipe Size-12"
M.R.P. ₹475/-

NW - 040BB

Brass-Pipe Size-15"
M.R.P. ₹575/-
HSN Code : 7418

"P" TRAP- Horizontal Bend Pipe



NW - 040CC

Brass-Pipe Size-15"
M.R.P. ₹625/-

NW - 040DD

Brass-Pipe Size-18"
M.R.P. ₹725/-
HSN Code : 7418

"P" TRAP



NW - 040B

"P" Trap Pipe Size 9 x 12" (40mm)
M.R.P. ₹540/-
HSN Code : 3917

ANGLE VALVE



NW - 041

Brass A/ Valve with Flange Size: 1/2" x 1/2"
M.R.P. ₹375/-
HSN Code : 8481

FUTURA PLUMBING ACCESSORIES

<p style="text-align: center; background-color: #e91e63; color: white; font-weight: bold; padding: 2px;">ANGLE VALVE SQUARE</p> <p style="text-align: center;">NW - 042</p> <p>Brass A/ Valve with Flange Size: ½ x ½ M.R.P. ₹450/- HSN Code : 8481</p>	<p style="text-align: center; background-color: #e91e63; color: white; font-weight: bold; padding: 2px;">ANGLE VALVE TRIANGLE</p> <p style="text-align: center;">NW - 042A</p> <p>Brass A/ Valve with Flange Size: ½ x ½ M.R.P. ₹450/- HSN Code : 8481</p>	<p style="text-align: center; background-color: #e91e63; color: white; font-weight: bold; padding: 2px;">SS 304 HEALTH FAUCET</p> <p style="text-align: center;">NW - 43</p> <p>1.5 Mtr SS Tube & Hook Finish - Satin M.R.P. ₹1050/- HSN Code : 8481</p>	<p style="text-align: center; background-color: #e91e63; color: white; font-weight: bold; padding: 2px;">SUPERIOR CONNECTION PIPE</p> <div style="display: flex; justify-content: space-between;"> <div style="width: 45%;"> <p style="text-align: center;">NW - 047</p> <p>Size: 18" PVC Connection Pipe Both side Brass Check Nut M.R.P. ₹150/- HSN Code : 3917</p> </div> <div style="width: 45%;"> <p style="text-align: center;">NW - 047A</p> <p>Size: 24" PVC Connection Pipe Both side Brass Check Nut M.R.P. ₹170/- HSN Code : 3917</p> </div> </div>
<p style="text-align: center; background-color: #e91e63; color: white; font-weight: bold; padding: 2px;">14MM SS FLEXIBLE CONNECTION PIPE ½" x ½"</p> <p style="text-align: center;">NW - 48A</p> <p>Size: 18" SS-304 Outer Hose EPDM Inner Hose with Chrome Nut Brass ½" M.R.P. ₹160/- HSN Code : 4009</p> <p style="text-align: center;">NW - 48B</p> <p>Size: 24" SS-304 Outer Hose EPDM Inner Hose with Chrome Nut Brass ½" M.R.P. ₹180/- HSN Code : 4009</p> <p style="text-align: center;">NW - 48C</p> <p>Size: 36" SS-304 Outer Hose EPDM Inner Hose with Chrome Nut Brass ½" M.R.P. ₹260/- HSN Code : 4009</p>	<p style="text-align: center; background-color: #e91e63; color: white; font-weight: bold; padding: 2px;">12MM SS FAUCET HOSE (PAIR-SHORT/LONG)</p> <p style="text-align: center;">NW - 49C</p> <p>Size: 450mm (18") SS-304 Grade Brided Faucet Hose M.R.P. ₹350/- HSN Code : 4009</p> <p style="text-align: center;">NW - 49D</p> <p>Size: 600mm (24") SS-304 Grade Brided Faucet Hose M.R.P. ₹425/- HSN Code : 4009</p>	<p style="text-align: center; background-color: #e91e63; color: white; font-weight: bold; padding: 2px;">PTMT CONNECTION PIPE</p> <div style="display: flex; justify-content: space-between;"> <div style="width: 45%;"> <p style="text-align: center;">NW - 045A</p> <p>Size: 18" PTMT Connection Pipe Both side PVC Check Nut M.R.P. ₹110/- HSN Code : 3917</p> </div> <div style="width: 45%;"> <p style="text-align: center;">NW - 045B</p> <p>Size: 24" PTMT Connection Pipe Both side PVC Check Nut M.R.P. ₹120/- HSN Code : 3917</p> </div> </div>	

Extension Nipple	Model No.	Specification	Finish	M.R.P.	Mode of Pack per Box
<p style="text-align: center;">HSN Code : 8481</p> <p style="text-align: center; font-size: small;">5" 4" 3" 2 1/2" 2" 1 1/2" 1"</p>	NW - 050	Brass Nipple Size-1"	Chrome Polish	₹ 78/-	36 pcs-ctn
	NW - 051	Brass Nipple Size-1 1/2"	Chrome Polish	₹ 114/-	24 pcs-ctn
	NW - 052	Brass Nipple Size-2"	Chrome Polish	₹ 140/-	18 pcs-ctn
	NW - 053	Brass Nipple Size-2 1/2"	Chrome Polish	₹ 170/-	6 pcs-ctn
	NW - 054	Brass Nipple Size-3"	Chrome Polish	₹ 210/-	5 pcs-ctn
	NW - 055	Brass Nipple Size-4"	Chrome Polish	₹ 285/-	12 pcs-ctn
	NW - 056	Brass Nipple Size-5"	Chrome Polish	₹ 435/-	6 pcs-ctn
	NW - 057	Brass Nipple Size-6"	Chrome Polish	₹ 455/-	6 pcs-ctn

<p style="text-align: center; background-color: #e91e63; color: white; font-weight: bold; padding: 2px;">Hex Nipple</p> <p style="text-align: center;">NW - 058</p> <p>Size: ½" Brass Hex Nipple M.R.P. ₹78/- HSN Code : 8481</p>	<p style="text-align: center; background-color: #e91e63; color: white; font-weight: bold; padding: 2px;">Elbow</p> <p style="text-align: center;">NW - 059</p> <p>Brass Elbow 2 Side Female M.R.P. ₹240/- HSN Code : 8481</p>	<p style="text-align: center; background-color: #e91e63; color: white; font-weight: bold; padding: 2px;">Elbow</p> <p style="text-align: center;">NW - 059A</p> <p>Brass Elbow 2 Side male M.R.P. ₹255/- HSN Code : 8481</p>	<p style="text-align: center; background-color: #e91e63; color: white; font-weight: bold; padding: 2px;">Elbow</p> <p style="text-align: center;">NW - 059B</p> <p>Size: Brass Elbow 1 Side M & 1 Side F M.R.P. ₹265/- HSN Code : 8481</p>	<p style="text-align: center; background-color: #e91e63; color: white; font-weight: bold; padding: 2px;">Tee</p> <p style="text-align: center;">NW - 060</p> <p>Brass Tee M.R.P. ₹240/- HSN Code : 8481</p>	<p style="text-align: center; background-color: #e91e63; color: white; font-weight: bold; padding: 2px;">Rack Bolt Screw</p> <p style="text-align: center;">NW - 065</p> <p>Rack Bolt Screw 5/8" M.R.P. ₹115/- HSN Code : 7415</p>
<p style="text-align: center; background-color: #e91e63; color: white; font-weight: bold; padding: 2px;">Rack Bolt Screw</p> <p style="text-align: center;">NW - 065A</p> <p>Rack Bolt Screw 5/8" M.R.P. ₹265/- HSN Code : 7415</p>	<p style="text-align: center; background-color: #e91e63; color: white; font-weight: bold; padding: 2px;">Rack Bolt</p> <p style="text-align: center;">NW - 066</p> <p>Rack Bolt Pair for EWC M.R.P. ₹550/- HSN Code : 7415</p>	<p style="text-align: center; background-color: #e91e63; color: white; font-weight: bold; padding: 2px;">Rack Bolt</p> <p style="text-align: center;">NW - 066A</p> <p>SS Rackbolt with ABS Cap M.R.P. ₹440/- HSN Code : 7415</p>	<p style="text-align: center; background-color: #e91e63; color: white; font-weight: bold; padding: 2px;">Waste Pipe</p> <p style="text-align: center;">NW - 068</p> <p>30" Long PVC Pipe with Brass Check Nut 1 ½" M.R.P. ₹210/- HSN Code : 3917</p>	<p style="text-align: center; background-color: #e91e63; color: white; font-weight: bold; padding: 2px;">Waste Pipe Flexible</p> <p style="text-align: center;">NW - 068A</p> <p>PVC Pipe with PVC Check Nut (Heavy) M.R.P. ₹65/- HSN Code : 3917</p>	<p style="text-align: center; background-color: #e91e63; color: white; font-weight: bold; padding: 2px;">Teflon Tape</p> <p style="text-align: center;">NW - 70A</p> <p>Size: 10 Yards M.R.P. ₹30/- HSN Code : 3919</p>

SALIENT FEATURES

ISO 9001 : 2015

We deliver consistent quality products as per ISO standardization.

For Stainless Steel Sinks. Except Accessories and Complements. Conditions apply.



TOPMOUNT SINKS

Top - mount sinks are installed into a kitchen counter - top so that a uniform working surface is created. Thin, and almost unnoticeable rims allows quick and easy cleaning. The installation is as simply as just put the sink from above into each type of kitchen counter - top.



UNDERMOUNT SINKS

Under - Mount sinks are installed into counter - top from below. Absence of seams between sink and counter- top contributes to simply hygiene maintenance and over all appeal of a kitchen.



INSET SINKS

With stylish details to the top edges, Futura inset sinks can be easily installed. It's simply about cutting a hole into your counter - top surface and mounting the sink with the clips provided.



Combination of Innovative design with traditional excellence.



Sound absording pads reduce the vibration and sound emitting from the sink when it is filled.



Futura latest technology and high-precision machines allow the manufacture of large and deep bowls for greater functionality, usability and durability.



Futura undercoating solution protect the sink from wet-rotted situation, as well as further make the sinks noticeably quiet.



The exposed surfaces are hand blended to a lustrous highlighted satin finish.

18/8
Stainless Steel

Highest quality sink formed from 18 guage, type 304 nickle bearing stainless steel.

CERTIFICATES

प्राप्त १
पंजीकरण प्रमाण-पत्र

अधिकार प्राप्त : U2811KA2011PTC089030 2011 - 2012

१) संस्थापक स्वतंत्रता का हक है कि वे चाहें
FUTURA KITCHEN SINKS INDIA PRIVATE LIMITED

२) संस्थापक, अपनी अधिकृत 1956 (1956 का 1) के अधीन और बिना १ और २ के अन्तर्गत स्थायी लिखित है।

३) यह सिंगल-एजेंट और सिंगल-एजेंट रूप में अपने स्वयं के वे प्रस्तावों में संलग्न है नहीं किया जा सकता है।

Form 1
Certificate of Incorporation

Corporate Identity Number : U2811KA2011PTC089030 2011 - 2012
I hereby certify that FUTURA KITCHEN SINKS INDIA PRIVATE LIMITED is the duly incorporated under the Companies Act, 1956 (No. 1 of 1956) and that the company is private limited.

Given under my hand at Bangalore this Seventh day of June Two Thousand

(Signature)
Deputy Registrar of Companies
BENGALURU
Karnataka

अधिकार प्राप्त : U2811KA2011PTC089030 2011 - 2012
FUTURA KITCHEN SINKS INDIA PRIVATE LIMITED
301, 1st Floor, Anand Tower, Old 5th Cross, 5th Stage, Saranagar Road, Bangalore - 560099, Karnataka, INDIA

Certificate No. 1912021

Certificate of Approval

This is to certify that the Quality Management System
of
Futura Kitchen Sinks India Pvt.Ltd.
Plot No. 19, 20 & 21, Bommasandra Industrial Area, Jigani Link Road
(Opp. BNR Export), Bangalore - 560 099, Karnataka, India,
has been examined by Assessors of QMS Certification Services Pvt. Ltd.
and found to be conforming to the requirements of
ISO 9001:2015
in respect of the following activities
Design, Development, Manufacturing & Supply of
Stainless Steel Kitchen Sinks and Stainless Steel
& Brass Plumbing & Sanitary Items

Current Issue Date 11/12/2018, Valid till 10/12/2021*
Original Certification 11/12/2018

(Signature)
Sanjay Kaushik
Managing Director

QMS **IAF**

* Subject to compliance with requirements specified in Service Specifications & Agreement
* To check the validity of this certificate please visit www.qmsonline.com

भारतीय मानक ब्यूरो
BUREAU OF INDIAN STANDARDS

REGISTRAR
Our Ref: CML-4702079

Subject: Grant of BIS Certification Marks License No. CML-4702079 as per IS 1393 : 1994

FUTURA KITCHEN SINKS INDIA PVT LTD,
PLOT NO. 19, 20& 21, BOMMASANDRA 2ND STAGE, OPP TO BNR EXPORT, JIGANI LINK ROAD,
BANGALURU
Distt : Bangalore Urban
Karnataka
560099

Dear Sir,
With reference to your application, we are pleased to inform you that it has been decided to grant you a license to use the Standard Mark in respect of the following:
Product: **Stainless Steel Sinks for domestic purposes**
IS No: **IS 1393 : 1994**

Type/Size/Grade/Variety covered under license:
Stainless Steel Sinks for domestic purposes, without topplate & overflow hole, Type A2 & C, 1000mm x 600mm workshop

2-The number assigned to this license is CML- 4702079 which has been made operative from 24/10/2014 and is valid upto 25/10/2021. The license number should invariably be referred to in your future correspondence.

3. According to sub-regulation (2) of Regulation 6 of Bureau of Indian Standards (Certification) Regulation, 1988, the license fee of Rs 1000/- and the marking fee of Rs. 41000/00 as stipulated in the Second Schedule of this license is payable by you with effect from 24/10/2014 for the period of validity of the license.

Service tax @ 12.36 % as applicable shall also be charged.

4.Minimum marking fee as stipulated therein is payable by you regardless of whether you actually mark your product for sale with the Standard Mark. Our Receipt No. 622478 dated 24/10/2014 for Rs. 47700/00 for the license for (Rs.1000/-) and the minimum marking enclosed/ sent separately.

5. This advance minimum marking fee will be carried over to the next year on every renewal. The actual marking fee calculated on the unit rate on the production marked or the minimum marking fee, whichever is higher shall be payable by you at the time of renewal.

उद्योग आधार
MSME

उद्योग आधार
MSME

Type of Enterprise	Micro	Small	Medium
Manufacturing	A	B	C
Services	D	E	F
UAI No.	R028008162		

Udyog Aadhaar Registration Certificate

Udyog Aadhaar Number: R028008162
Name of Enterprise: FUTURA KITCHEN SINKS INDIA PRIVATE LIMITED
Location of Plant Details:

Sl. No.	Plot/Door/Block No.	Name of Premises/Building Village	Road/Street Lane	Area	Pin Code	State	City/Town/Village
1	PLOT NO. 19,20,21	2ND STAGE	JIGANI LINK ROAD	BOMMASANDRA INDUSTRIAL AREA	BANGALORE560099	KARNATAKA	BENGALURU (RURAL)

Official Address of Enterprise: PLOT NO. 19,20 & 21, 2ND STAGE, JIGANI LINK ROAD, BOMMASANDRA INDUSTRIAL AREA, BANGALORE
District: BENGALURU (RURAL) State: KARNATAKA Pin: 560099
Mobile No: 735372019 Email: rajendra@futuresink.com

Date of commencement: 31/10/2010
Major Activity: MANUFACTURING
Enterprise Type: Small
Previous Registration details if any: .
National Industry Classification Code:

SN	NC 2 Digit	NC 4 Digit	NC 5 Digit Code	Activity Type
1	25	2586	25865	Manufacturing

Acknowledgement: Date of Filing: 03/12/2018 Date of Printing: 03/12/2018

Disclaimer: This is a computer generated statement, no signature required.
Printed from udyogaadhaar.gov.in

MSME Mobile App (Beta Version) is available now for download: <https://play.google.com/store/apps/details?id=com.msme.msme>

महाराष्ट्र मूल्यांकन व क्षेत्रविकास प्राधिकरण
MAHARASHTRA ECONOMIC AND AREA DEVELOPMENT AUTHORITY

महाराष्ट्र
MHADA

APPROVAL LETTER No: CE/EE-1/A/ 159 /2018
Date: 26/05/18

To: M/s Futura Kitchen Sinks India Pvt.Ltd.
2/2, Mandeth Mansion,
1st Main, BTS Main Road, Lakshansandra Extension,
Wilson Garden, Bengaluru-560030.

Sub Vendor and product Registration for use in MHADA works.

Ref: 1) Your letters dated 26/05/17 and 03/08/17 addressed to the Chief Engineer-I/A.
2) Your letters received on 02/12/2017, 23/02/2018, 06/03/2018 and 27/03/2018 addressed to the Executive Engineer-I/A.
3) This office letter nos. 249/17 dt. 29/06/2017, 369 dt. 27/09/2017, 465 dt. 29/11/2017, 497 dt. 22/12/2017

Sir,
This has reference to your above said letters and subsequent correspondence on captioned subject matter. As requested, your proposal for registration of "Stainless Steel Sinks and Plumbing Accessories in both stainless and brass fittings" for use in MHADA projects is hereby approved on the following terms and conditions:

Terms and Conditions:

- The validity of the endorsement shall be for **TWO YEARS** from issue of this letter. However, the MHADA reserves the right to cancel the same.
- The product shall be in conformity with requirements of specifications of Bureau of Indian Standards. BIS registration has to be taken as earlier as possible and the same shall be intimated to this office.
- The approval has been granted on the basis of documents/information furnished by the vendor. The approval would be cancelled if any details are found in variance to the details already furnished during the inspection of manufacturing unit. MHADA reserves the right to visit the manufacturing unit at any time.

Sd/-
Rajendra
11/11/18

CITY AND INDUSTRIAL DEVELOPMENT CORPORATION OF MAHARASHTRA LIMITED
CIDCO

BISCO OFFICE:
"NIRMAL", 2nd Floor, Nehru Park,
Mumbai - 400 021.
PHONE: 33-41-25-2830/3963
FAX: 33-41-25-2222/2529

HEAD OFFICE:
CIDCO Bhawan, CIDC Bhawan,
New Mumbai - 400 014.
PHONE: 33-41-22-4791/5102
FAX: 33-41-22-4791/5196

Ref. No: CIDCO/EE (PA & R) / P-1362 / 2019 / 1 / 02 Date: 26.03.2019

To: Futura Kitchen Sinks India Private Limited,
Plot No. 19, 20 & 21, Bommasandra 2nd Stage,
Opposite BNR Export, Jigani Link Road,
Bengaluru-560 099.
Tel: 080-4204 3451, Mob: 92434 36123,
Contact Person: M. Bhavesh K. Jain,
Mob: +91-93200 09620, E-mail: bhavesh@futuresink.com

SUB: Registration as an Approved Vendor
Ref: Your application vide file no P-1362-2018

Dear Sir,
With reference to your request application on subject matter, we are pleased to inform you that your registration as an approved vendor for our projects / works for the following products is approved herewith for a period of **Two (02) years**.

S. No	Material description	Material Name/ Brand /Size / Range
1	Stainless Steel Kitchen Sinks as per IS 13983:1994, Abrn IS & Hand Carved Series	Stainless Steel Kitchen Sinks Brand: "Futura"
2	Stainless Steel, Brass Plumbing Accessories	Stainless Steel, Brass Accessories Brand: "Futura"

Kindly note that:
a) The validity of the endorsement is said for **Two (02) Years** i.e. up to **28.03.2021**. However, the Corporation reserves the right to cancel the same in case complaints are received from users within that period.

In case of any corruption related complaints, please visit:
cidco.maharashtra.gov.in / CIDCO VIGILANCE MODULE NEW / Userlogin.aspx

Futura®

NEW PLUMBING ACCESSORIES RANGE

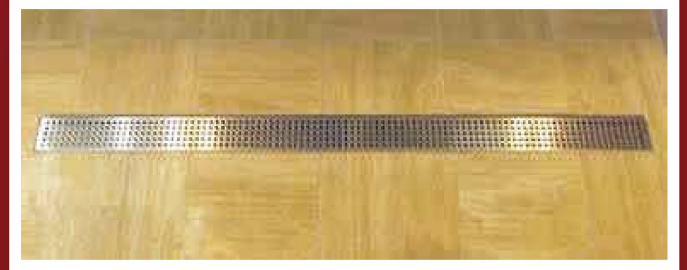
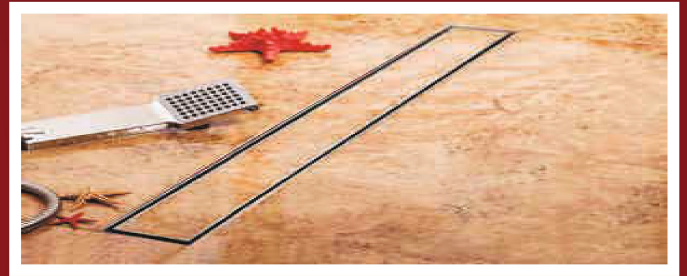

Futura®

SINKS THAT THINK

FUTURA KITCHEN SINKS INDIA PVT. LTD.

CORPORATE OFFICE & SHOWROOM

FUTURA SINKS STUDIO

2/2, Mandoth Mansion, 1st Main, BTS Main Road,
Lakkasandra Extension, Wilson Garden, Bengaluru - 560 030. (INDIA)

Ph : 080-22128042 / 22104536

Working Hours : Mon-Sat 10 am - 6pm

Mob : +91 92434 16868 / +91 81972 37173  : +91 94827 57575

Email : enquiry@futuresink.com/venoway@yahoo.co.in

Works :

Plot No. 19, 20 & 21,

Bommasandra 2nd Stage,

Opp. BNR Export, Jigani Link Road,

Bengaluru-560 099.

Ph : 08110414794, Mob : +91 92434 35126

Mumbai Branch Office :

Unit 901, 9th Floor,

Suntech Grandeur,

Fish Market, Near Subway,

SV Road, Navneeth Colony,

Andheri, Mumbai 400058

Ph: +91 93200 05626

 : +91 93200 05625

Maharashtra Warehouse :

Shop No:11, Bldg:3 , Ext:3,

Rajprabha Udhyog Nagar,

Golani Naka, Vasai (East)

T : +91 93200 05622

www.futuresink.com

Price List w.e.f : 01.06.2023